

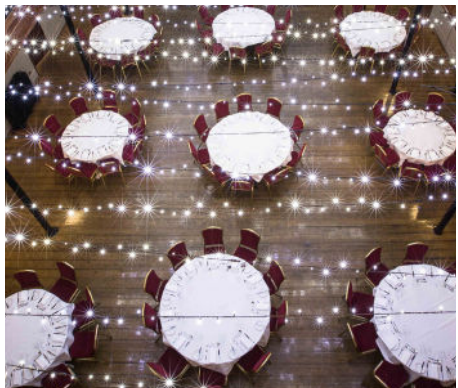

# Event Spaces

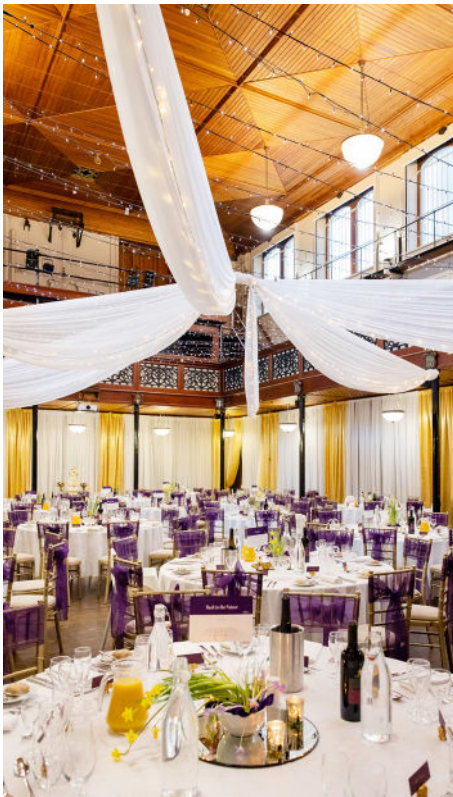

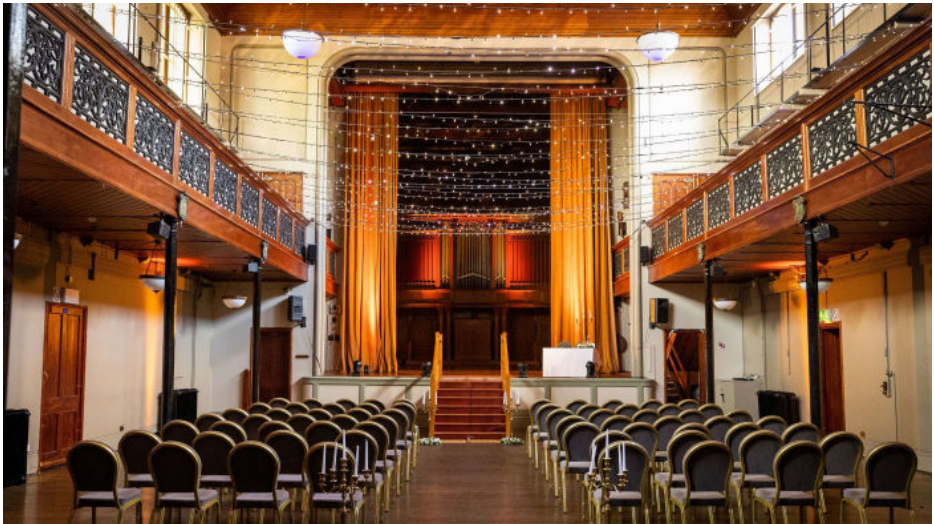



# The Science Theatre

## Layouts

Standing	350
Dining - Round Tables	220
Theatre	220
Exam Style	70
Classroom	77
Cabaret	120
U-Shape/Boardroom	68
AV Equipment	Projector Screen Speakers Microphone
Wheelchair Access	Yes

## Dimensions

Length (to stage)	19.45 metres
Length (between pillars)	16.90 metres
Width	12.20 metres



# The Theatre Bar

## Layouts

Standing	100
Seating	20
Wheelchair Access	Yes

## Dimensions

Floor Area	53.84 square metres
------------	---------------------

# The Conservatory

## Layouts

Dining	36
Informal Seating/Standing	40
Wheelchair Access	Yes

## Dimensions

Length	11 metres
Width	5 metres





# The Drawing Room

## Layouts

Standing	150
Dining - Round Tables	93
Dining - Long Tables	100
Theatre	120
Cabaret	60
Cabaret	120
AV Equipment	Speakers Microphone
Wheelchair Access	Yes

## Dimensions

Length	13.25 metres
Width	8.30 metres







# The Gold Room

## Layouts

Dining	30
Theatre	40
Classroom	18
Cabaret	24
U-shape	20
Boardroom	20
AV Equipment	Speakers 42" plasma screen
Wheelchair Access	Yes

## Dimensions

Length	5.75 metres
Width	8.60 metres

# Leighton

## Layouts

Boardroom	30
Dining	36
Theatre	50
Classroom	18
Cabaret	24
U-shape	24
AV Equipment	Speakers 42" plasma screen
Wheelchair Access	Yes

## Dimensions

Length	9.60 metres
Width	5.30 metres





# Vera Bryce

## Layouts

Boardroom	32
Long/Round Tables	50
Theatre	60
Cabaret	40
U-shape	24
Circle of Chairs	20
AV Equipment	Projector and Screen Speakers
Wheelchair Access	Yes

## Dimensions

Floor Area	83.42 square metres
------------	---------------------





# Douglas Bennett

## Layouts

Boardroom	18
Theatre	20
Classroom	18
Cabaret	18
Circle of Chairs	16
U-shape	16
AV Equipment	Projector and Screen Speakers
Wheelchair Access	No

## Dimensions

Length	6.40 metres
Width	6.10 metres

# Laura de Stern

## Layouts

Boardroom	24*
Theatre	34*
Classroom	12
Cabaret	18
Circle of Chairs	18
U-shape	16
AV Equipment	Projector and Screen Speakers
Wheelchair Access	No

*\*Breakout space recommended*

## Dimensions

Floor Area	51.29 square metres
------------	---------------------



# Newton

## Layouts

Boardroom	8
AV Equipment	Plasma screen Speakers
Wheelchair Access	Yes

## Dimensions

Floor Area	27.05 square metres
------------	---------------------







# Reginald

## Layouts

Boardroom	8
Circle of Chairs	8
Wheelchair Access	No

## Dimensions

Length	3.7 metres
Width	3.5 metres

# Ground Floor

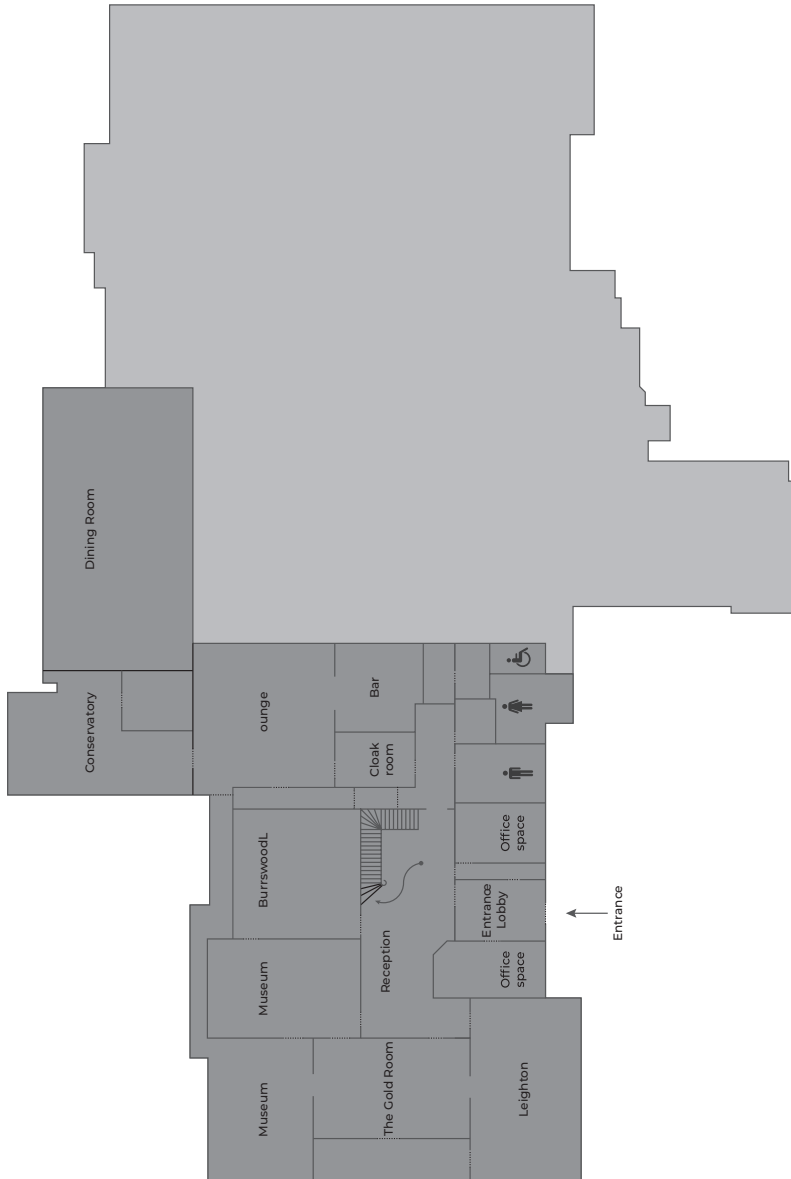

# First Floor

